



INSTALLATION GUIDE

High-Density Fibre cement

Prefabricated Panels & installation systems

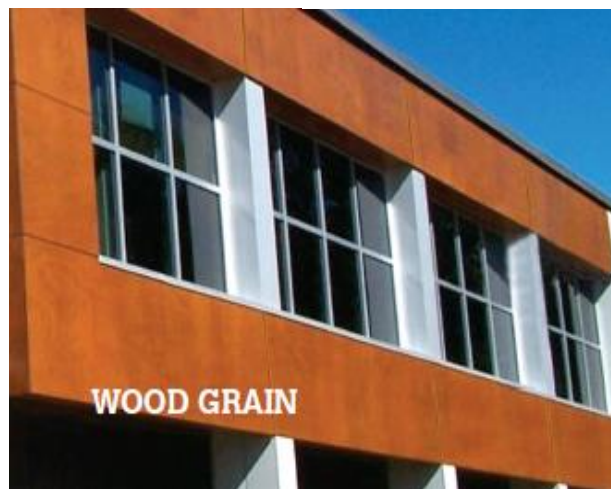

TABLE OF CONTENTS

DIMENSIONS: STANDARD SERIES	3
PRIOR TO INSTALLATION	3
MERCHANTISE CHECK UP.....	3
SECURITY.....	3
HANDLING.....	4
STORAGE.....	4
PROVIDED TOOLS & ACCESSORIES.....	5
ON-SITE CUTTING & INSTALLATION TOOLS.....	6
PANEL CUTTING.....	6
ENAMEL TOUCH UP (ON-SITE).....	6
MAINTENANCE.....	7

INSTALLATION METHODS

TRIM-FIT SYSTEM- PRESSURE MOLDING ATTACHMENT SYSTEM

PREPARATION.....	8
PROCEDURE.....	9
DETAILS / INSTALLATION DIAGRAM JUNCTIONS.....	10
DETAILS / INSTALLATION DIAGRAM.....	11

PRESS-FIT - FACE FASTENER SYSTEM

PREPARATION.....	12
PROCEDURE.....	13
TYPICAL DETAILS / INSTALLATION DIAGRAM.....	15

DIMENSIONS: STANDARD SERIES (PANEL)

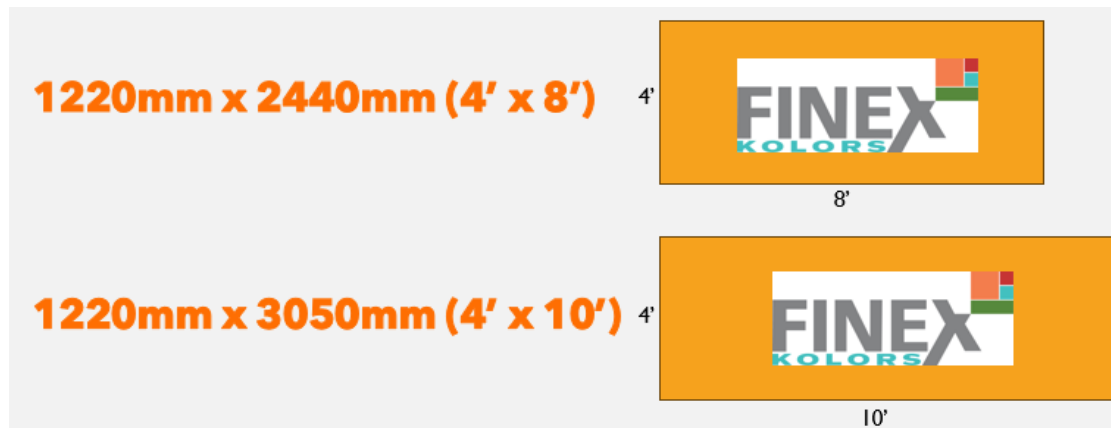

Note : Custom panel fabrication available upon request, with supplement.

PRIOR TO INSTALLATION

MERCHANDISE CHECK-UP

IMPORTANT: Upon arrival of merchandise on site, shipment should be inspected carefully by the installer, in case of any breakage or irregularity - if so, please notify **FINEX**. Any damaged products should NOT be used. Any product with an anomaly/defect that is installed will be declared "Accepted As-Is" by the client.

SECURITY

- It is strongly recommended to wear gloves when handling boards and wear a mask and safety glasses when cutting and drilling panels.
- If irritation occurs, we recommend rinsing the affected area with cool water.
- If discomfort or irritation persists, consult a doctor immediately.

HANDLING

Remove the panels of their delivery pallet by lifting one side at a time

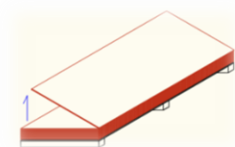
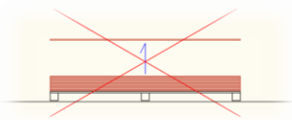

Always carry the panels vertically

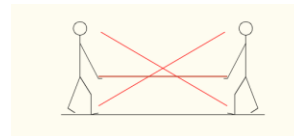

NOTE: For handling large panels, we recommend using glass carriers.







STORAGE

- Merchandise must be stored in an enclosed area, away from water/snow, excessive moisture or anything else that could damage your order.
- If an enclosed area for storage is not possible, make sure to have and apply a protective tarp on the materials pallets to avoid any water/snow accumulation/infiltration into the pallets. This tarp needs to allow for ventilation to avoid any excessive moisture. Humidity/water accumulation may result in damaging the surface of the panels. Exterior storage should not be longer than 3 months.
- Panels shall be placed flat on a surface free of protrusions. Pallets having only full-size panels (4' x 8' and 4' x 10') on them can be stacked two high. If your order includes custom fabricated panels, the pallets cannot be stacked.
- Be sure to keep the colored enamel and sealer provided for touch-ups at room temperature (minimum of 8°C (45°F) and up to 40°C (105°F)).
- At each end of a workday, cover the products with their original tarp to prevent any water/snow/dirt infiltrating the pallet and potentially damaging the products.

NOTE: DO NOT COVER DIRECTLY ENAMELED SURFACE OF A WOOD PRODUCT. ACIDS COULD ALTER THE ENAMEL.

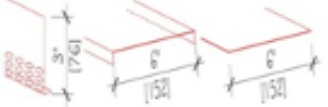
PROVIDED TOOLS & ACCESSORIES

The following table summarizes the tools and accessories supplied with respect to the selected installation method.

Tools & accessories	TRIM-FIT	PRESS-FIT
Screw types	Metal, 1" in length	Metal, 1-1/2" in length
	Wood, 1" in length	Wood, 1-1/2" in length
Drill bit	Not Applicable	 <p>Titanium or carbide drilling drill bit : 8.3 mm (21/64") for pre drilling</p>
Back strips and moldings for ventilation	<p>Back strips not applicable,</p> <p>Trim-Fit Design: see p.9</p>  <p>Ventilation grill included</p>	 <p>Back strip galvanized steel satin 24 gauges, enameled, length 3050mm (10')</p>
Interface ribbon	Not Applicable	 <p>Interface ribbon 25 mm (1") length and 6 mm (1/4") thick, self-adhesive in rolls of 10.6m (35')</p>
Adhesive	 <p>(For 1220 series)</p>	Not Applicable
Fastener	Enameled Screws	Enameled Screws
Sanding block beveling		Sanding block and fine paper
Enamel		Enamel for touch-ups (edges only)

For additional information: (450)373-0909 or info@gofinex.com (client care).

ON-SITE CUTTING & INSTALLATION TOOLS

This includes cutting edges of windows, ducts, electrical outlets, unanticipated adjustments, etc.

High -speed circular saw (min 4000 revolutions per /minute) with finishing blade (60 teeth minimum) carbide or titanium tipped.



Router with titanium or carbide-tipped blade.



Laser



Jigsaw with titanium or carbide-tipped blade.



Sawing plate with titanium or carbide blade.



Note: Be sure to use titanium or carbide blades and drill bit to make precise cuts and use a guide to ensure straight and rectilinear cuts.

PANEL CUTTING

For on-site cutting:

- Place a sheet of plywood between the saw and the panel to prevent damages to the enameled surface;
- Place the panel in order to have the finished surface up and protect it from slipping tools or other material;
- Have a continuous guide to ensure a straight edge;
- Use a finishing blade (60 teeth minimum- 8" diameter) with carbide or titanium tip;
- Using enamel supplied by the manufacturer, paint the new edge.



ENAMEL TOUCH-UPS: ON-SITE (FOR EDGES ONLY)

NOTE: Ambient and Substrate temperature must be higher than 8°C during application and 3 hours after

Surface Preparation :

- Using the grade #80 sandpaper included in your order, slightly bevel all corners to eliminate sharp edges;
- Using a clean damp cloth, carefully clean the freshly cut area.

Mixing and Enamel Application for all On-Site Cuts :

- Using a stick, mix the content of the colored enamel supplied with the FINEX KOLORS panel on delivery;
- Using a foam roller or a soft sponge, apply without pressure enamel on the edge of the cut or on flaking, taking care to avoid spillage on the surface already colored. In that event, immediately wipe any spills with a clean cloth;
- Allow 30 minutes to dry;
- Apply a second coat and let dry 30 minutes before handling the panels.

*Always follow directions on the container. Paint is for **panel edges only**. For any correction on the panel's surface, please connect with your representative for more information.*

MAINTENANCE

NOTE: It is important during the pre-drilling and on-site cutting to immediately remove any dust to avoid damaging the surface. Dust from cutting and pre-drilling left on the surface may solidify with rain/humidity and stain it permanently

- For cleaning, use a sponge and a nonabrasive household detergent diluted in water, rinse thoroughly with clean water. Soft bristle brush may be used. Do not use any solvent based or acid product. After installing the siding, make sure the panels are free of dust.
- Pressure washing can be carried out within a maximum pressure of 100 psi, using a cleaning nozzle with a wide jet. A minimum distance of 1m (3') of the panels should be always kept at all times.

VENTED FACADES

Do not apply Finex Kolors panels directly to studs or structural timber. Ensure **adequate and continuous ventilation** of the rear wall cavity to comply with the *National Building Code* standards in effect and the principle and standards of the **ventilated rain screen** assembly. A ventilation gap of 25mm (1") needs to be considered at the bottom of the wall, top of the wall and at the top of wall openings.

Width of the rear wall cavity behind the panels:

Wall facades less than 20' in height = 18mm (3/4")

Wall facades 20' and over in height = 30mm (1-1/4")

WALL ASSEMBLY PREPARATION

- Construct the wall system as stated in the drawings and according to the composition described in the wall description tables. The cladding steel framing shall be aligned with each other with a maximum deviation of 3mm (1/8") on 2440mm (8 ft).
- For ceilings or soffits, make sure the dead weight (including the weight of the panel, etc) does not exceed 48 kg/m² (10lb/sq.ft) and the ventilation is sufficient, thus avoiding condensation at the back of the panels. The thickness of the panels should be 10 mm or 12 mm (3/8", 1/2"). The furring should have a maximum space of 400 mm (16 inches).
- Metal or wood furring are acceptable for the installation of the Finex Kolors cladding system. Make sure at all times that the flatness of the supports is constant. Refer to the specified installation system section for further details.
- **Ground Clearance:** To avoid any damage to the panels, it is advised to keep a minimum distance of 150mm (6") between the bottom of the panel and ground.

TRIM-FIT[®] SYSTEM

PRESSURE TRIMS ATTACHMENT SYSTEM

PREPARATION

Vertical metal furring (20g)

Furring (« **Z** » bars or « hat channels ») must be spaced at a maximum of 400mm (16") for walls, ceilings and soffits and should be discontinued at the meeting of a building construction joint and floor. Furring should match the architectural horizontal joints. In addition to meeting the maximum spacing just mentioned, supports must be 75mm (3") wide « hat channel » type matching the architectural joints and 1-1/2" at intermediary supports.

Vertical wood furring (SPF)

Wood furring must be spaced at a maximum of 400mm (16") for walls, ceilings and soffits and should be discontinued at the meeting of a building construction joint and floor level. Furring should match the architectural vertical joints in addition to meeting the maximum spacing mentioned above and must be 75mm (3") wide. Wood furring must be covered with an EPDM membrane or equivalent to avoid direct contact between the wood and concrete and to avoid long term wood degradation. If a panel adhesive is used, do not apply the EPDM membrane on the intermediary supports. At the exterior and interior corners of the cladding, install an appropriate support of 75mm X 75mm (3" x 3") on the back of the panel to provide support and help get a straight angle.

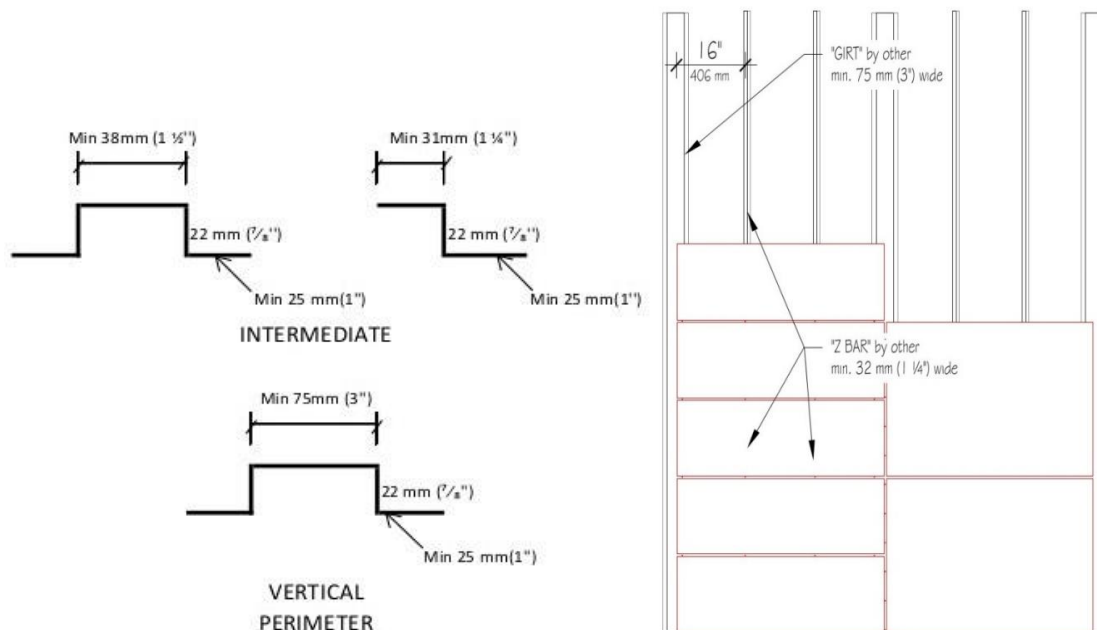

Pressure Trims - System

Aluminium extruded molding T-6 grade, enameled with sealing compressible closed cell foam on the rear surface fins.

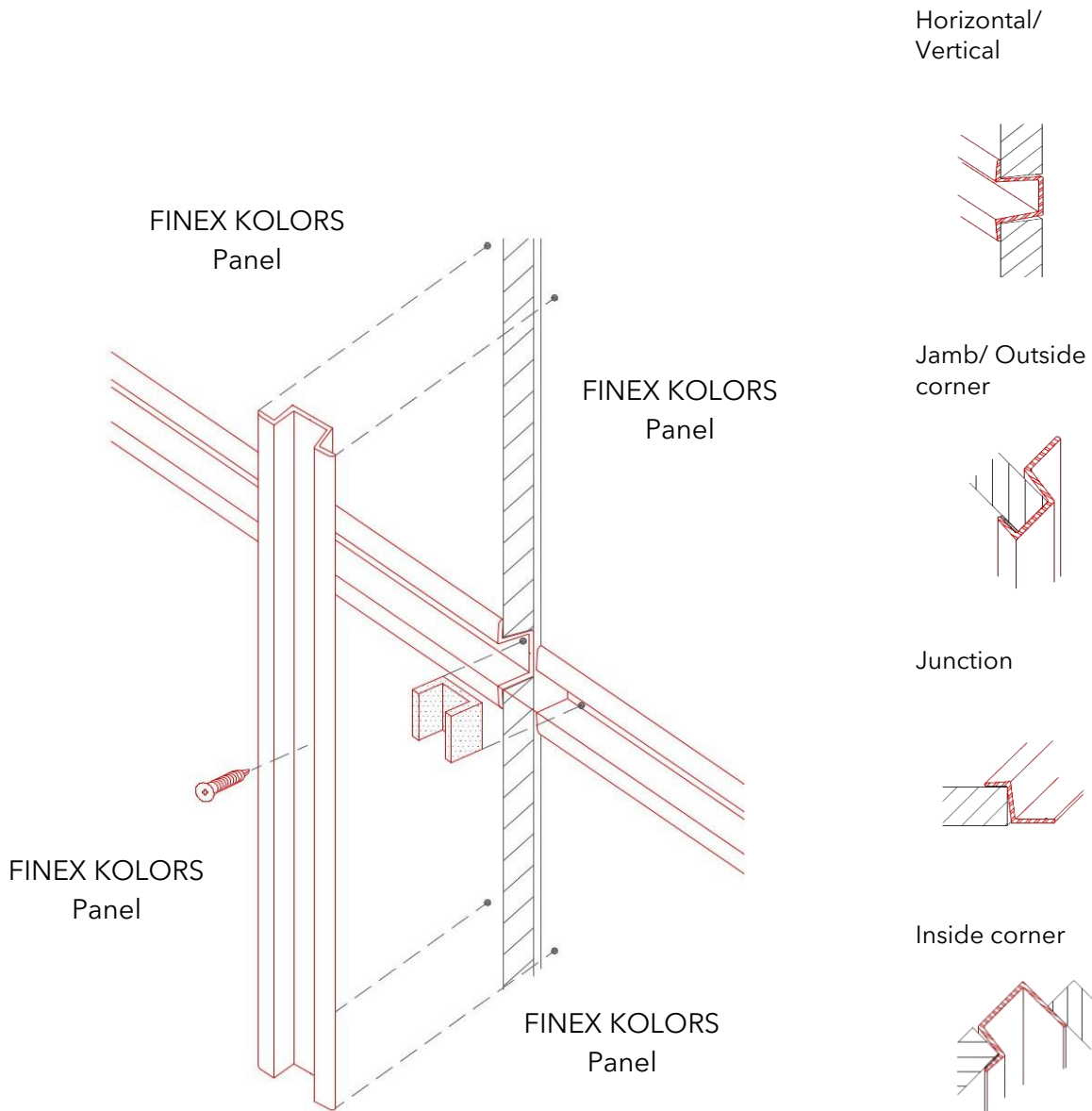

* All trims / moldings are pre-finished in factory to match color of panel

* Trims / moldings come in lengths of 10', adjustable on site.

PROCEDURE

1. ASSEMBLY

- Construct the wall system as stated in the drawings and according to the composition described in the wall description tables. The cladding steel framing shall be aligned with each other with a maximum deviation of 3mm ($\frac{1}{8}$ inch) on 2440mm (8 ft).
- For the ceilings or soffit, be sure dead weight (including the weight of the panel, etc) does not exceed 48 kg/m² (10lb/sq.ft) and ventilation is sufficient, thus avoiding condensation at the back of the panels. The thickness of the panels should be 11 mm ($\frac{7}{16}$ " in.). The furring should have a maximum space of 400 mm (16 inches).
- For wall application, do not assemble the panels directly on the wall studs. Install the steel furring (omega shape) at the panel's perimeter. Make sure the ventilation is adequate in the wall cavity. The vertical omega furring must be of a maximum width of 400 mm (16"). They should be aligned with each other with a maximum deviation of 3mm ($\frac{1}{8}$ in) on 2400mm (8"). The furring and cladding should be discontinued at the building construction joint. The vertical omega furring should be of 75 mm (3") length towards the vertical architectural lines. The maximum deflection of the building including the frame should be within L/360. The contractor should assure the architect has approved the support before having the Finex Kolors panels installed.

2. SIDING INSTALLATION

- Select the appropriate trim in the range of press-trim moldings, as the situation requires. The installation concept of the Finex Kolors involves the setting of the panel by a perimeter pressure molding; "Trim-Fit®". Use of a construction laser is recommended to ensure moldings consistency.
- **Note: For panels used as ceiling or over 610mm width, add a mounting of elastomeric adhesive at the panel's center on the full length of intermediary support (follow the sealant manufacturer's instructions). Do not apply / install if temperatures are below zero (0) Celsius.**
Important: make sure of the straight alignment of the "Trim-Fit®" moldings at all time.
- First place the appropriate "Trim-Fit®" junction/starter pressure molding to the panel set. Partially fix the trim to each of the vertical hat channel furring, using 25mm (1") stainless steel screws. Slide the Finex Kolors panel in the upper part thereof, pressuring the panel with the length of the trim/support. Position a horizontal molding on the upper part on the panel. Adjust the molding with panel's length. Partially fix the trim with 25mm stainless steel screws on each hat channel furring. Secure the lower molding by fixing it completely; subject its winglet with panel's surface without deforming it. Repeat the above steps for each Finex Kolors panel.
- **Note:** Plan using the ventilated grill "Trim-Fit®" at the bottom and top of the wall and wall's ridge opening. This grill is included in the system. A spacing of 25mm (1") between Finex Kolors panel and flashing must be planned for proper air flow.
- When panels are horizontally fixed with "Trim-Fit®" pressure moldings, insert a compressible foam coin inside both ends of adjacent horizontal pressure moldings. Important: subject the compressible foam piece inside the horizontal pressure molding. Position the appropriate "Trim-Fit®" pressure molding vertically, overlapping horizontal moldings and compressible foam pieces. Joint only when it meets horizontal moldings. Make sure the compressible foam piece is subjected to the cavity in the cross meeting of the vertical and horizontal moldings. Attach the molding with 25mm stainless steel screws at 405mm (16") c/c of the vertical fur and at intersection of architectural lines, press it without deforming it. Make sure that the straight alignment is maintained at all time.
- when meeting a window/door frame or another siding material, use the starter/junction 'trim-fit®' to make the connection/transition with the finex kolors cladding.

TYPICAL DETAILS - INSTALLATION DIAGRAM

TRIM-FIT®

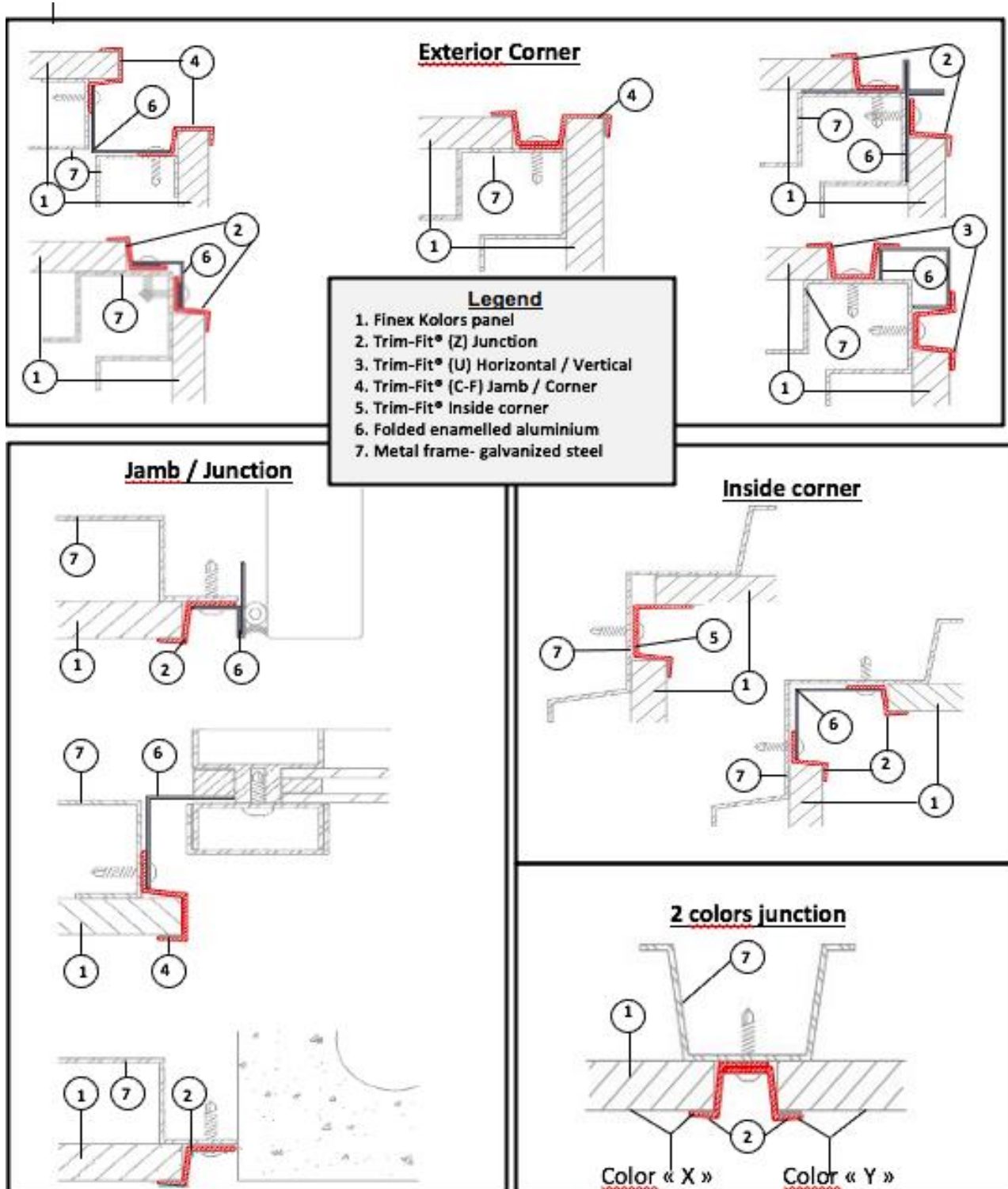

PRESS-FIT SYSTEM- SURFACE FASTENERS

Vertical Furring (20g Caliber Minimum)

Furrings (« **Z** » bars or « hat channels ») must be spaced at a maximum of 400mm (16") for vertical surfaces as well as for ceilings and soffits and should be discontinued at the meeting of a building construction joint and floor. Furring should match the architectural horizontal joints, in addition to meeting the maximum spacing just mentioned and must be 150mm (6") wide « hat channel » type at the architectural joints and intermediary supports should be 30mm (1-1/4') wide. At the exterior and interior corners of the cladding, install an appropriate folded support of 75mm X 75mm (3" x 3") caliber 20, on the back of the panel to provide support and help get a straight angle.

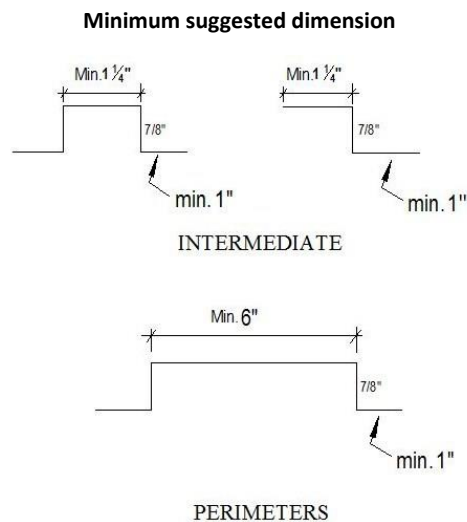

Vertical wood furring (SPF)

Wood furring must be spaced at a maximum of 400mm (16") for walls, ceilings and soffits and should be discontinued at the meeting of a building construction joint and floor level. Furring should match the architectural vertical joints in addition to meeting the maximum spacing mentioned above. Wood furring must be double at vertical architectural joints to obtain 150mm (6") width and single 75mm (3") width at intermediary supports. Wood furring must be covered with an EPDM membrane or equivalent to avoid direct contact between the wood and concrete and to avoid long term wood degradation. At the exterior and interior corners of the cladding, install an appropriate support of 75mm X 75mm (3" x 3") on the back of the panel to provide support and help get a straight angle

PROCEDURE

1. Back Strip : Horizontal

- Place the back strip to the corresponding horizontal architectural joints.
- Temporarily** secure the back strip on furring as specified on the frame plans, the panels' fasteners will keep them in place. See **Picture 1**

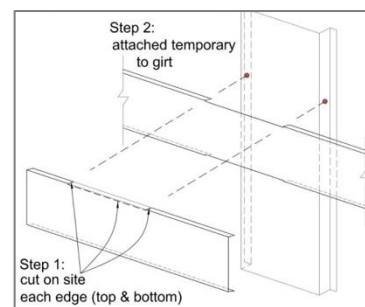

Picture 1

2. Back Strip : Vertical

- The back strip must have a minimum size of 50mm (2") to the rear edge of the panel, in addition to the spacing of the joint as specified on plans.
- Place ongoing length for vertical joints. Vertical back strip must overlap the horizontal back strip;
- Temporarily** secure the back strip on furring as specified on the frame plans, the panels' fasteners will keep them in place.

3. Ventilation Grill

- Perforated vent grills are included with materials. Position these (see **Picture 2**) at the bottom of the cladding, above the openings and at the height of the wall. A spacing of minimum 25mm (1") should be planned to allow proper ventilation.

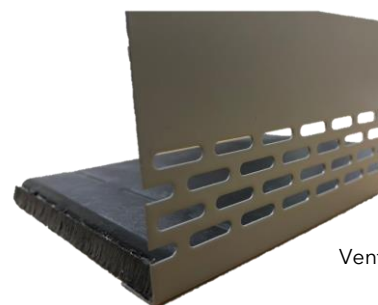

Ventilation Grill

4. On-Site Pre-Drilling Press-Fit

Instructions:

- Pre-drill the panel using the drill bit provided with your order. Screw holes must be 2mm wider than diameter of fastener to allow expansion of panel.
- FREQUENCY:** Vertical = 600mm (24"), Horizontal = 400mm (16").
- Immediately remove any dust to avoid surface damage.

Interface ribbon (to the rear panel)

- Position the flexible self-adhesive ribbon directly to the outer edge of the back of the panel. Ribbon must be positioned at 25mm (1") from the edge of the panel and on 3 edges of the panels (not panel's bottom edge).

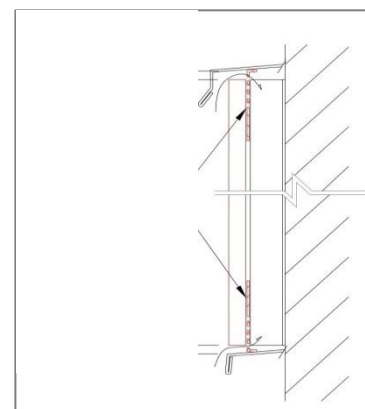

Picture 2

Fixing to the Furring:

- Start the installation of fasteners through the center panel;
- Fasten panels to vertical furring using only fasteners provided by **FINEX**.
- Fasteners must be positioned asymmetrically at the panel's corners at least 38 mm (1.5") of edge and 64 mm (2.5") from the top** with a maximum spacing of 600mm (24") vertically and 400mm (16") horizontally or as specified on plans;
- Insert the centering guide **first in the pre-drilled hole**. The centering guide will direct the fastener in the center of the pre-drill hole of 8.3mm ($2\frac{1}{64}$ "), allowing space around the fastener for the physical expansion/ contraction of the panel.

- Keep a minimum distance of 3mm ($1/8$ ") between panels, according to specifications described in the plans.
- In the inside and outside corners, install a 20 gauge galvanized steel bracket of 75mm x 75mm (3" x 3") at panel rear to provide support and help get a straight angle.
- Start the fastening of panels by the screws in the center and move towards exterior of panel.

Ventilation

- Ensure a minimum clearance of 25mm (1") between panels and flashing, at the height of the openings and to the top and bottom of the wall to allow ventilation and proper drainage. Ventilation back strips are included with the system.

Ceilings and Soffits

- For ceilings and soffits, make sure there is sufficient ventilation to avoid condensation on the rear of the panel. The furring should be spaced at 400mm (16") maximum.

Important Notes

- The steel supports shall be 20 gauge or more (see description on plans);
- Galvanization layer thickness on steel must be of Z275g/m²;
- Vertical furring (a minimal distance of 6mm ($1/4$ ") between the joint junctions) should be discontinued at the junction of a horizontal joint between two panels. Example : at the junction of floor stages;
- Press the panel at 1mm ($1/32$ ") from the back strip surface : do not crush it on the back strip. **Do not use impact tools;**
- Place the panel in it's final position. Holes positionned in the center must be of identical diameter as fasteners. Start the installation of fasteners through the center panel.



TYPICAL DETAILS - INSTALLATION DIAGRAM

PRESS-FIT

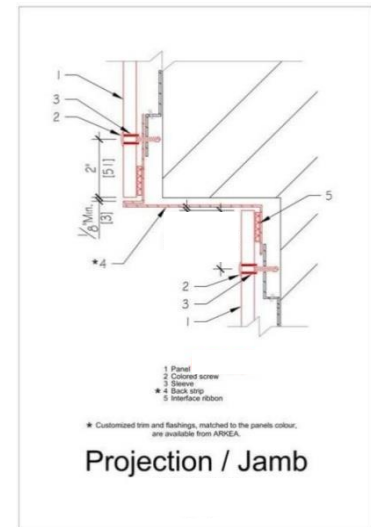
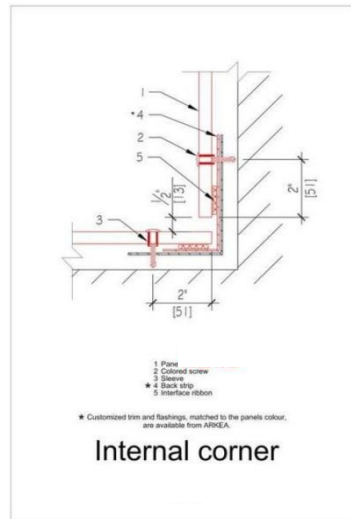
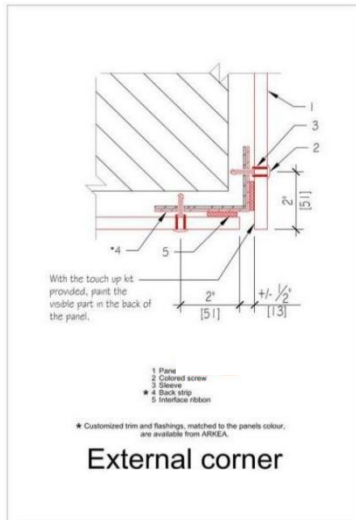

A

B

PANEL FASTENING TO FURRING

Due to the attachment points of the furring and panels, when they take their expansion on two different furrings as in example A; the expansion of both materials is equal. When panels are to expand on two furrings as in example B; uneven pressure is then exerted on the panels and can cause potential damage.

This means that:

- It is recommended that vertical furring be discontinued at the junction of floor levels to allow its deformation absorption; see example A
- The vertical furring must not exceed 3050 mm (10') long;
- For smaller parts, it is possible to set them on the same metal sleeve subject to compliance with the two points above;
- Ground Clearance: Finex Kolors panels must stay at a 150mm (6 ") distance from floor, sidewalks, etc.

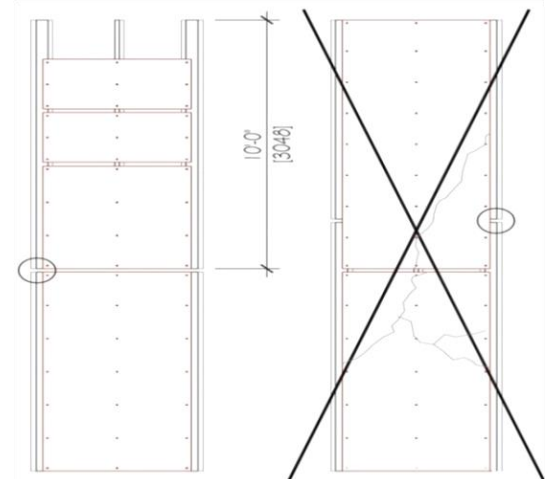



FINEX HEAD OFFICE

1915 Alfred-Nobel St.

Salaberry-de-Valleyfield (Quebec) Canada J6T 0E3

Tél. : (450) 373-0909

info@gofinex.com

Always refer to the latest version of this guide, available on our site

www.gofinex.com

Last update.; 06-2024